

We reserve all right in connection with this document and in the subject thereof. By acceptance of the document the recipient acknowledges these rights and undertakes not to publish the document nor the subject thereof in full or in part, nor to make them available to any third party without our prior express written authorization, nor to use it for any purpose other than for which it was delivered to him.

SW

A B C D E F

DENTURE	
Profil	Norme Chronode
Plan de profil	P8-246 / F
N° Fraise	S50-006 / A
Déport de taillage	0
Nbre de dents	44
Module	0.09
ø total	4.170
ø sur 4 dents	4.159 +5/-10
ø primitif	3.96
ø de fond	3.645 +10/-12

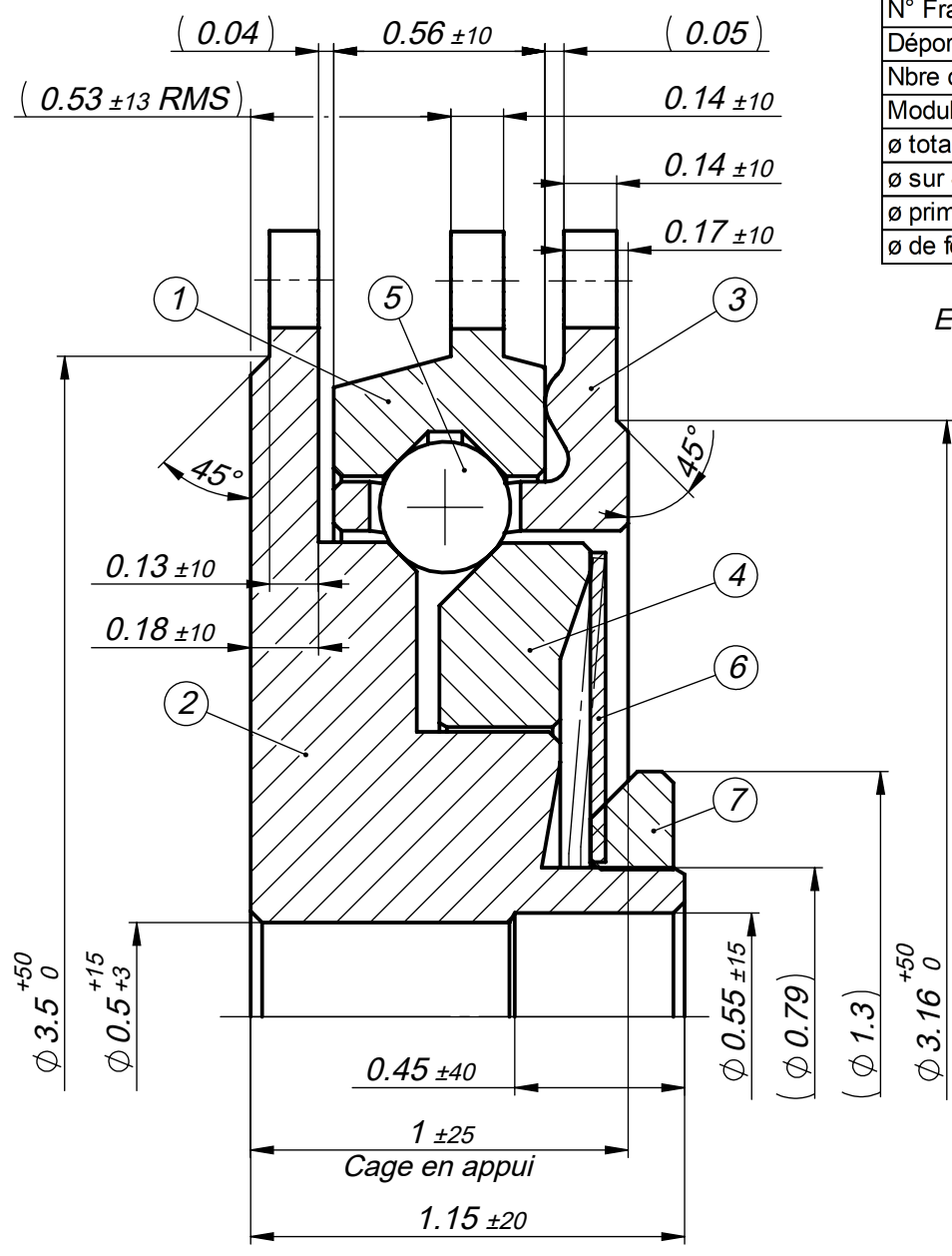

Ech.: 15:1

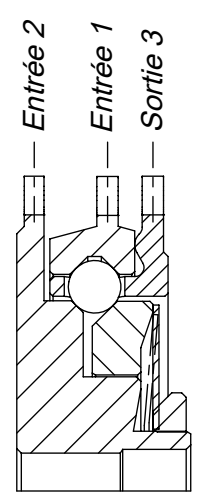
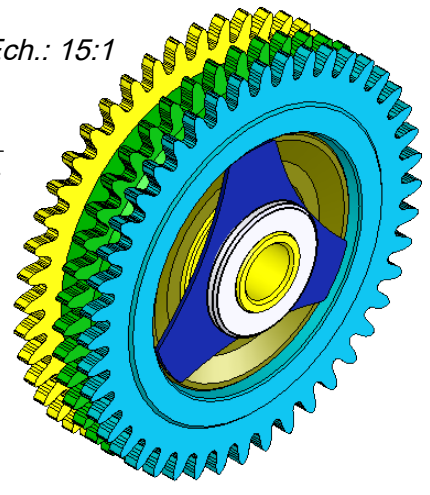

Rapport de transmission i à la sortie 3

si l'entrée 1 est bloquée, $i = 0.4546$
 si l'entrée 2 est bloquée, $i = 0.5454$

Matière:
 - Composants en Ac. inox, dureté HV 625 ±50
 - Billes en myrox (Zr O2)

ø billes : 0.347
 ø primitif : 2.70

Moment de friction: 70 / 130 µNm

Ech.: 1:1
 Anglage générale 0.03 x45°

Matière		Usinage général		Cotes en mm - Tolérances en µm Tol. générales selon ISO 2768-FH : Angles: ± 2° Dimensions: <0.5 ±30µ, ≥0.5...6 ±50µ, ≥6...30 ±100µ, ≥30...120 ±150µ		Echelle 50:1
Remplace		Poli		Designation du client		
Remarque		Ensemble		Designation		Format A4V
		Projet		SM 1544XZRY / 09		
Visa		Date		N° identification		Page 1/1
Dessiné squillantef		01.01.2001		6630.01544.09		
Contrôlé squillantef		09.04.2019		MPS Micro Precision Systems AG		Ind. 01
Libéré buih		09.04.2019		MPS Micro Precision Systems AG		
Modifié SquillanteF		09.04.2019		MPS Micro Precision Systems AG		